



2025 ATI General Assembly

Domestic Revenue Mobilisation: a turning point for achieving the SDGs

22-24 JULY | ADDIS ABABA, ETHIOPIA (HYBRID)

Funded by



Co-funded by
the European Union

Facilitated by





Seville Declaration on Domestic Revenue Mobilisation



Stay up to date on ATi latest events, publications, and activities

Summary

Day 1 22 July 2025	
Time (GMT+3)	Sessions
09:30 – 09:50	Opening
09:50 – 10:10	Keynote address
10:10 – 12:10	Presentation of the Seville Declaration on DRM
12:10 – 13:30	Lunch break
13:30 – 15:00	Panel discussion: advancing progressive taxation: experiences, challenges and successes from ATI partner countries
15:00 – 15:30	Break
15:30 – 17:00	Spotlight session I
18:30 – 20:30	Reception

Day 2 23 July 2025		
Time (GMT+3)	Sessions	
09:00 – 09:15	Summary of day one and setting the scene for day two	
09:15 – 10:45	Technical session I: Loss of tax revenues in the mining sector: new insights and best practices for policy and administration	Technical session II: Taxation and the informal economy: lessons and best practices
10:45 – 11:15	Break	
11:15 – 12:45	Spotlight session II	
12:45 – 14:00	Lunch	
14:00 – 16:00	Marketplace	
16:00 – 17:45	Parallel sessions: meeting of Consultative Groups 1 and 2	

Day 3 23 July 2025	
Time (GMT+3)	Sessions
09:00 – 09:15	Summary of day two and setting the scene for day three
09:15 – 11:00	Parallel sessions: meeting of Consultative Groups 3 and 4
11:00 – 11:30	Break
11:30 – 12:30	Tax gap estimation in ATI partner countries
12:45 – 13:45	Lunch
13:45 – 14:45	Assessing the fairness and equitability of tax systems: environmental and gender considerations
14:45 – 15:45	Closing panel
15:45 – 16:00	Closing
17:00 – 20:00	Cultural event

ATI General Assembly 2025

2025 marks the 10th anniversary of the Addis Tax Initiative (ATI), founded during the 3rd International Conference on Financing for Development in 2015. Over the past decade, the ATI has supported partner countries in implementing the Addis Ababa Action Agenda. Through policy advocacy, knowledge building, and partnerships, the ATI has increased international support for Domestic Revenue Mobilisation (DRM), expanded its network, and played a crucial role in international tax cooperation.

Despite the progress made, we face growing challenges such as shrinking fiscal spaces, mounting debt levels in partner countries, violent conflicts, political instabilities and declining budgets for international cooperation. These challenges call for a strong coalition of the willing to enhance international cooperation for better *tax systems that work for people and advance the Sustainable Development Goals (SDGs)*.

With the 4th Financing for Development Conference and the *Seville Declaration on Domestic Revenue Mobilisation*, the ATI stands at a critical juncture. The 2025 ATI General Assembly serves as a platform to reflect on ATI's progress and challenges since 2020, and to present and discuss the *Seville Declaration on DRM*.

Technical exchanges, opportunities for policy advocacy and networking shall nurture the effectiveness of the ATI. Further, the 2025 General Assembly shall strategically guide the ATI, bring the needs and priorities of ATI partner countries to the fore and strengthen members' engagement to implement the *Seville Declaration on DRM* and its actions.

The event is organised by the International Tax Compact (ITC), in its role as the facilitator of the ATI Secretariat, in close cooperation with the ATI Steering Committee. The ITC is funded by the German Federal Ministry of Economic Cooperation and Development and co-funded by the European Union.

Extended programme

Day 1 – 22 July 2025

Time (GMT+3)	Session
09:30 – 09:50 <i>Room: Nile hall</i>	Opening remarks by Martina Metz , Director for Development Economics and Development Banks, Federal Ministry H.E. Javier Niño Pérez , EU Ambassador to the African Union Peter Ringsted , ATI Co-Chair, Norwegian Agency for Development Cooperation (NORAD) Kayula Chimfwembe , Assistant Director, Ministry of Finance and National Planning, Zambia
09:50 – 10:10 <i>Room: Nile hall</i>	Keynote address Dr. Stephen Karingi , Director of the Regional Integration and Trade Division, United Nations Economic Commission for Africa (UNECA)
10:10 – 12:10 <i>Room: Nile hall</i>	Presentation of the Seville Declaration on DRM „This session will provide participants with a deep understanding of the new „Seville Declaration on DRM“. Representatives of the ATI post-2025 Task Force will provide a high-level overview before participants will familiarise themselves with the 4 Actions via a gallery walk. Speakers: Alistair Lobo , Tax and Economic Growth Lead, Foreign, Commonwealth and Development Office (FCDO), United Kingdom John Ikata Oyekuodi , Head Tax Expenditure Management, Federal Inland Revenue Service (FIRS), Nigeria Paula Schindeler , Deputy Head of Mission, Dutch Embassy to Ethiopia
12:10 – 13:30	<i>Lunch break</i>
13:30 – 15:00 <i>Room: Nile hall</i>	Panel discussion: Advancing progressive taxation: experiences, challenges, and successes from ATI partner countries This session will explore practical experiences and emerging solutions in progressive taxation, with a particular emphasis on taxing high-net-worth individuals and innovative instruments such as global solidarity levies. Experts and decision-makers from around the world will share challenges, successes, and best practices to support fairer tax systems and sustainable development in ATI partner countries. Speakers: Margaret P. Krote , Acting Commissioner, Domestic Tax Department, Liberia Revenue Authority Wilson Prichard , Associate Professor, University of Toronto and Chair, Local Government Revenue Initiative (LoGRI) Mark Lester Aure , Executive Director, National Tax Research Center, Philippines Mehdi Hassan , Secretary International Taxes, Revenue Division, Federal Board of Revenue, Pakistan Ronald Waiswa , Specialist, Applied Research and Statistics Unit, African Tax Administration Forum (ATAF) Yussuf Hussein , Climate Finance Advisor to the Special Envoy on Climate, Office of the President of Kenya
15:00 – 15:30	<i>Break</i>

15:30 – 17:00

Spotlight session I

Room: Nile hall

This session offers ATI members a platform to present recent work in domestic revenue mobilisation (DRM), aligned with the General Assembly's theme and the ATI Declaration 2025. Through peer learning and exchange, participants will share successes and challenges in designing and implementing DRM-related reforms and projects, fostering dialogue and collaboration across the ATI community.

Speakers:

Amie Kolleh Jeng, Director of Public Finance Management, Ministry of Finance, Gambia

Joseph Dokekana, Commissioner of Inland Revenue; Solomon Islands

Leila Kituyi, African Tax Administration Forum (ATAF)

Austin Ndiokwelu, Senior Director, Global Advocacy, Policy and Partnerships, International Budget Partnership (IBP)

Mohidul Islam Mohidul, Additional Commissioner - National Board of Revenue, Bangladesh

Madan Dahal, Director General - Inland Revenue Department Nepal

18:30 – 20:30

Reception

Day 2 | 23 July 2025

Time (GMT+3)

Sessions

09:00 – 09:15

Summary of day one and setting the scene for day two

Room: Nile hall

Moderator

09:15 – 10:45

Technical session I: Loss of tax revenues in the mining sector: new insights and best practices for policy and administration

The session will provide a mapping of main risks for revenue in the mining sector in ATI partner countries and address potential instruments and mechanisms to increase revenues. A recent study across eight ATI partner countries to explore the patterns, risks, and financial implications of tax evasion in the gold trade will be presented and discussed.

Moderator:

Viola Tarus, Policy advisor, International Institute for Sustainable Development (IISD)

Speakers:

Marc Ummel, Head of Unit Raw Materials, SWISSAID

Thomas Lassourd, Lead, Tax and Extractives, International Institute for Sustainable Development (IISD)

Room: Afework Tekle hall

Technical session II: Taxation and the informal economy: lessons and best practices

The technical session, co-organised with the International Centre for Tax and Development (ICTD), will explore innovative strategies to progressively expand the tax base and adapt tax practices to evolving economic realities. Discussions will address the limitations of common approaches to taxing the informal economy and highlight new strategies such as risk-based registration, targeted taxation of self-employed professionals, and the integration of tax systems with social protection mechanisms.

Moderator:

Regina Navuga, Tax Equity Manager, International Budget Partnership (IBP)

Speakers:

Max Gallien, Research Lead, International Centre for Tax and Development (ICTD)

Denis Mukama, Interim Commissioner, Strategy and Risk Analysis Department, Rwanda Revenue Authority

Guillermo Montt, Social Protection Specialist, International Labour Organisation (ILO)

Room: Nile hall

10:45 – 11:15

Break

11:15 – 12:45
Room: Nile hall

Spotlight session II

This session offers ATI members a platform to present recent work in domestic revenue mobilisation (DRM), aligned with the General Assembly's theme and the ATI Declaration 2025. Through peer learning and exchange, participants will share successes and challenges in designing and implementing DRM-related reforms and projects, fostering dialogue and collaboration across the ATI community.

Speakers:

Birhanu Tadesse Daba, Principal Associate, International Bureau of Fiscal Documentation (IBFD)
Amina Ebrahim, Research fellow, United Nations University World Institute for Development Economic Research (UNU-WIDER)

Viola Tarus, Policy advisor, International Institute for Sustainable Development

Gunilla Näsman and Henrik Lund, Ministry of Finance, Sweden

Imiangaly Randrianomana, Head of Department, Promotion of Civic Tax Responsibility and Communication, Direction Générale des Impôts, Madagascar

12:45 – 14:00

Lunch

14:00 – 16:00
Room: Skylight Open space

Marketplace

This interactive session offers ATI members a space to showcase reform plans, share support opportunities, and explore partnerships aligned with domestic revenue mobilisation (DRM) priorities. Through physical booths and direct exchange, partner countries, development partners, and supporting organisations can connect, collaborate, and identify opportunities for technical and financial cooperation in support of sustainable development.

Booths:

Birhanu Tadesse Daba, Principle Associate, International Bureau of Fiscal Documentation (IBFD)
Thomas Lassourd, Lead, Tax and Extractives, International Institute for Sustainable Development (IISD)

Imiangaly Randrianomana, Head of Department, Promotion of Civic Tax Responsibility and Communication, Direction Générale des Impôts, Madagascar

Austin Ndiokwelu, Senior Director, Global Advocacy, Policy and Partnerships, International Budget Partnership (IBP)

Emmanuel Eze and Leila Kituyi, African Tax Administration Forum (ATAF)

Abena Larbi Odam, Associate Communications Officer, United Nations University World Institute for Development Economic Research (UNU-WIDER)

Henrik Lund and Gunilla Näsman, Ministry of Finance, Sweden

Max Gallien, International Centre for Tax and Development (ICTD)

Wilson Prichard, Chair of the Local Government Revenue Initiative (LoGRI)

16:00 – 17:45
Room: Nile hall

Parallel sessions:
Meeting of Consultative Group 1

The promising approach of tax data-labs in improving the operation of tax administrations.

Speakers:

Amina Ebrahim, Research fellow, United Nations University World Institute for Development Economic Research (UNU-WIDER)

Room: Nile hall

Parallel sessions:
Meeting of Consultative Group 2

How can ATI partners pique the interest of philanthropies and how can the ATI play a role in coordinating the needs and priorities of members countries?

Speakers:

Michael Jarvis, Executive Director of the Trust, Accountability and Inclusion Collaborative (TAI)

Room: Afework Tekle hall

Day 3 | 23 July 2025*Time (GMT+3)**Sessions***09:00 – 09:15****Summary of day two and setting the scene for day three***Moderator***16:00 – 17:45***Room: Nile hall***Parallel sessions:****Meeting of Consultative Group 3**

Insights from CbCR Training for ATI Partner Countries.

Speakers:

Miroslav Palansky, Head of Research at the Tax Justice Network

Mulay Weldu Asegehegn, Head of Tax Policy Department, Ministry of Finance, Ethiopia

*Room: Nile hall***Parallel sessions:****Meeting of Consultative Group 4**

Strengthening tax compliance through civic engagement and understanding the politics of public trust.

Speakers:

Austin Ndiokwelu, Senior Director, Global Advocacy, Policy and Partnerships, International Budget Partnership (IBP)

Wilson Prichard, Chair of the Local Government Revenue Initiative (LoGRI)

*Room: Afework Tekle hall***11:00 – 11:30***Break***11:30 – 12:30***Room: Nile hall***Tax gap estimation in ATI partner countries**

This session will present findings from recent research done on tax gap compliance estimation and reduction approaches in ATI partner countries.

Speakers:

Shan Zhong, Senior Economist, Fiscal Affairs Department International Monetary Fund (IMF)

Joseph Sirengo, Chief Manager, Research and Surveys at Kenya Revenue Authority

Amina Ebrahim, Research fellow, United Nations University World Institute for Development Economic Research (UNU-WIDER)

This session is co-organised with the IMF's RA-GAP team.

12:45 – 13:45*Lunch*

13:45 – 14:45
Room: Nile hall

Assessing the fairness and equitability of tax systems: environmental and gender considerations

This session will present the application of the Fair Tax Monitor (a tool launched by Oxfam, TJNA, and partner CSOs as a global research and advocacy initiative to assess national tax systems' fairness and effectiveness) to assess the gender equitability of tax systems, and the effectiveness and equitability of environmental tax policy. After the presentation, a discussion of the results of FTM tool applied in ATI partner countries will follow.

Speakers:

Henrique Alencar, Policy Advisor for Fair Tax, Oxfam Novib

Ishmael Zulu, Senior Policy Officer - Tax and Equity Tax Justice Network Africa (TJNA)

Gwladys Tankeu, Deputy Head of Project - Gender Equality in Taxation Expertise France

Veronicah Ndegwa, Senior Research Analyst Revenue Policy, Institute of Public Finance (IPF)

Nkombo Mwiinga, Senior Budget Analyst, Budget Office, Ministry of Finance, Zambia-Summary

14:45 – 15:45
Room: Nile hall

Closing panel

As the 2025 ATI General Assembly draws to a close, this final plenary session offers space to reflect on key takeaways from the three-day event and to look ahead as the ATI enters a new phase. Featuring an open fishbowl discussion, all members are invited to share feedback, strategic insights, and priorities for the future—especially in light of the new Seville Declaration on DRM and recent global developments. The session will conclude with a summary of highlights and messages for collective action moving forward.

15:45 – 16:00
Room: Nile hall

Closing

Wrap-up of the General Assembly by the moderator

Final remarks by the ATI Co-Chairs

17:00 – 20:00
Totot restaurant

Cultural event

A dinner in an Ethiopian restaurant combined with a traditional dance performance shall round off the 2025 ATI General Assembly.

ATI Monitoring Report Executive Summary

The Addis Tax Initiative (ATI) is a multi-stakeholder partnership comprising 77 partner countries, development partners, and supporting organisations. Its mission is to promote fair and effective domestic revenue mobilisation (DRM), strengthen policy coherence, and enhance partnerships and knowledge building, focusing on partner country needs.

Launched at the Third International Conference on Financing for Development (FfD) in Addis Ababa, Ethiopia, in July 2015, the ATI initially focused on the ATI Declaration 2020, which outlined three core commitments to support DRM through 2020. In November 2020, ATI members reaffirmed their commitment by adopting the ATI Declaration 2025, which introduces four core commitments to advance DRM efforts. Since its inception, the ATI has seen significant growth in membership. It now includes 33 partner countries from across Africa, Asia, South America, and the Pacific; 20 development partners; and 24 supporting organisations, including international institutions, private foundations, and research bodies.



ATI Commitment 1: *ATI partner countries commit to enhance DRM on the basis of equitable tax policies as well as efficient, effective and transparent revenue administrations. ATI development partners commit to support such reforms.*

The average revenue-to GDP ratio for ATI partner countries was 17.7% in 2021 and 16.15% in 2022, compared to 16.9% in 2020. Tax revenues comprised 84.2% of total revenue in 2021 and 84.8% in 2022, compared to 84.4% in 2020. The largest source of tax revenue in 2021 were taxes on goods and services (44.8%), while in 2022 taxes on income, profit and capital gains were the most significant source (41%)¹.

Progress is also evident in the adoption of targeted tax policies. Seven ATI partner countries reported implementing tax measures to promote gender equality by 2023, compared to two in 2020. 12 partner countries adopted tax measures to support environmental sustainability by 2023, doubling from six in 2020.

By 2022, 29 ATI partner countries had Large Taxpayer Offices, with a further eight having set up units engaging High Net Worth Individuals. Trends in timeliness of tax filings and payments between 2020 and 2022 show mixed progress across key tax types. Outliers contributed to significant fluctuations in aggregate performance metrics and may reflect prolonged recovery from the COVID-19 pandemic and temporary tax relief

¹ 2023 data is not yet available.

measures, as well as variation in data sources used to compile payment and filing statistics.

Out of 16 ATI partner countries responding to tax gap-related survey questions, 11 reported having recently conducted tax gap analyses (up from eight in 2020), with many focusing on VAT. In 2022, the closing stock of arrears across ATI partner countries averaged 52.4% of total tax revenue, ranging widely from 0.7% to 514.3%. Large variations in closing stock of arrears may be due to the economic shocks of COVID-19 lockdowns in 2020 and 2021, where levels of non-compliance increased, and revenue potential decreased. While economic conditions gradually began to improve by 2022, progress has been slow to return to pre-COVID levels.

In 2023, 35.7% of Official Development Assistance (ODA) for DRM provided by ATI development partners included aims to promote equity outcomes and 32.3% supported efforts to enhance the efficiency, effectiveness, and transparency of tax administrations.



ATI Commitment 2: *ATI development partners collectively commit to maintain or surpass the 2020 global target level (USD 441.1 million) of DRM cooperation for country-owned tax reforms.*

In 2023, gross ODA for DRM disbursed totalled USD 281.1 million, marking a 20.3% decrease compared to 2020. Despite this decline, ODA for DRM has increased by 17.5% since 2015. However, ATI development partners remain USD 160 million short of their collective 2025 target. In 2022 and 2021, development partners disbursed USD 345.12 million and 349.73 million, respectively. Notably, 13 out of 20 development partners have more than doubled their ODA for DRM at least for one year between 2021 and 2023.

ODA for DRM in 2023 reached at least 98 countries, with ATI partner countries Tanzania, Ghana, and Indonesia among the top ten recipients. Of the 33 ATI partner countries, 18 received increased ODA for DRM compared to 2022. The Sub-Saharan Africa region was the largest regional recipient, accounting for 21% of total disbursements. An increasing share of ODA is being directed to unspecified developing countries. In terms of income classification, 43.2% of ODA disbursements in 2023 were unallocated by income group. Least Developed Countries (LDCs) were the second-largest group, receiving 24.6%, down from 35% in 2020.

Project-type interventions continue to be the dominant form of DRM support, comprising nearly 60% of total disbursements. 13 ATI development

partners identified specific ways they are promoting a country-owned approach to their DRM-related ODA.



ATI Commitment 3: *ATI members commit to apply coherent and coordinated policies that foster DRM and combat tax-related illicit financial flows (IFFs).*

The 2023 peer review on harmful tax practices issued recommendations for one ATI development partner. Of the 19 ATI government development partners², 18 are signatories to both the Multilateral Convention to Implement Tax Treaty Related Measures to Prevent Base Erosion and Profit Shifting (MLI) and the Country-by-Country Multilateral Competent Authority Agreement (CbC MCAA).

Notable progress was observed in 2023, as the number of compliant tax agreements under BEPS Action 6 increased significantly, from 373 in 2020 to 746 in 2023. There were 116 active bilateral exchange relationships under the CbC MCAA between ATI development partners and partner countries, up from 35 in 2020. The number of ATI development partners with activated bilateral exchange relationships increased from just two in 2020 to seven in 2023.

In 2021, four development partners underwent Stage 2 peer reviews under BEPS Action 14 regarding their Mutual Agreement Procedure (MAP) provisions. Although no additional peer reviews occurred in 2022 or 2023, many development partners continue working toward full compliance with Action 14.

As of 2023, only Denmark, the Netherlands, and Ireland had conducted spillover analyses to assess the impacts of their tax policies on the ability of other countries to raise domestic revenue.

Among ATI partner countries, 26 have published tax expenditure data, with 17 doing so regularly, compared to 13 regularly reporting out of 21 partner countries with published tax expenditure data in 2020. Despite this progress, about half still do not include tax expenditure information in their supporting budget documentation for the fiscal year.

In terms of tackling illicit financial flows (IFFs), 18 of the 19 ATI government development partners (excluding the United States) are signatories to, and have begun implementing: the Common Reporting Standard (CRS) Multilateral Competent Authority Agreement (MCAA) for Automatic Exchange of Information (AEOI); and

² This excludes the EU, as individual countries are signatories.

the Amended Multilateral Convention on Mutual Administrative Assistance in Tax Matters for Exchange of Information on Request (EoIR).

By 2023, 11 ATI partner countries had also become signatories to the CRS MCAA.

Efforts to strengthen legal frameworks for identifying and registering beneficial owners show mixed results. However, where data is available for partner countries, there is a discernible reduction in financial secrecy.



ATI Commitment 4: *ATI members commit to enhance space and capacity for accountability stakeholders in partner countries to engage in tax and revenue matters.*

In 2023, 22 ATI partner countries published tax or revenue strategies, doubling the number reported in the 2020 Monitoring Report. Additionally, 27 partner countries publicly reported revenue raised by individual tax types, while eight reported tax revenues by economic sector.

Across ATI partner countries, 63% published disaggregated tax revenue data and included multi-year revenue estimates by category in their national budget processes. On tax expenditure transparency, 12 countries published some relevant information. However, many reports lacked key elements, such as the policy rationale, a list of intended beneficiaries, and estimates of foregone revenue.

Data on revenue foregone concerning taxes on goods and services, income, and property was available for 23 ATI partner countries. However, reporting on property tax expenditures remains both limited and relatively low compared to other tax types.

In terms of public engagement, analysis from the Open Budget Survey (OBS) suggests modest progress since the 2021 OBS. Public engagement on tax matters remains limited, particularly during budget formulation, implementation, and legislative phases. Challenges also persist regarding advance provision of information to citizens and the effective use of public feedback mechanisms.

In 2023, 17% of total ODA for DRM aimed to promote accountability, transparency, and the involvement of non-state actors in tax policy. However, only 4.5% of total ODA for DRM was directly channelled to civil society organisations as primary implementing partners.

Logistical note

Greetings from Addis Ababa, Ethiopia's capital and diplomatic hub. We are pleased to welcome you to Capital Hotel & Spa for the ATI General Assembly 2025. This guide provides essential travel information, local attractions, and practical advice to ensure a comfortable and productive stay.

Venue details

Capital Hotel & Spa Haile Gebreslassie Road, Addis Ababa Phone: +251 116 391 000

Website: www.capitalhotelandspa.com

This five-star hotel is known for its excellent service, fitness center, health spa, and spacious conference facilities.

Event dates & schedule

Dates: July 22–24, 2025

Daily sessions begin at 9:00 AM. A detailed agenda will be provided upon arrival in your welcome pack. You can also access the agenda [here](#).

Arrival & visa information

- Bole International Airport (ADD) is Ethiopia's main international airport.
- Visa should have already been obtained before your travel. Have the visa information printed just in case.
- Airport transfers may be arranged through the hotel; please confirm your flight details in advance. If you are a sponsored guest, your travel information has already been communicated to the hotel.

Weather in July

- Addis Ababa's rainy season begins in July. Expect: Temperatures: 12°C – 22°C (54°F – 72°F) and mildly cold climate with frequent showers.
- Recommended packing: closed-toe shoes and a lightweight rain jacket.

Transportation arrangements

Airport transfer:

- Estimated travel time from Bole International Airport (ADD) to Capital Hotel & Spa: 30 minutes.

- Complimentary hotel shuttle service is available for guests staying at Capital Hotel & Spa.
- To ensure timely arrangements, please provide your: Flight number, Arrival date and time, Contact information to the hotel concierge at least 4 day prior to arrival.

Currency & payments

The local currency is the Ethiopian Birr (ETB). Approximate exchange rates (as of July 2025):

- 1 EUR ≈ 150 ETB
- 1 USD ≈ 132 ETB
- 1 ZAR ≈ 7.5 ETB

Cash is recommended. Card payments are not widely accepted – do not rely on them. If you need to exchange money, Commercial Bank of Ethiopia and Bole International Airport arrivals hall are recommended exchange locations.

People & culture

Ethiopia is the second most populous country in Africa, with over 120 million people. More than 5 million live in Addis Ababa. Nearly 40% of the population is under 15 years of age.

Due to the vast size of the population, it is important to recognise that descriptions of Ethiopian cultural customs can vary significantly. There are many distinct cultural practices that are specific to people's region, ethnicity or religion. With over 80 ethnic groups and languages, Ethiopia is one of the most ethnically and linguistically diverse countries in the world. Despite this diversity, Ethiopians often share a strong sense of national pride and unity.

The term „Habesha“ is commonly used to refer to people from the Ethiopian and Eritrean highlands, regardless of ethnicity.

City attractions & activities

Outdoor activities

- **Entoto Natural Park** – Panoramic views, nature trails, and cultural pavilions on the beautiful Entoto Mountain chain encompassing Addis. A paradise for outdoor adventurers with dozens of engaging activities i.e. jogging trials, mountain biking, zip line, horse riding, archery, paint ball & rope challenges.
- **Street Walk** – If you are an enthusiast of

strolling or bike riding while gazing on amazing city skylines then streets of Addis are just for you. The sprawling streets of Bole, Churchill, Piassa and Kazanchis are full of parks, cafes, water works and playgrounds you can thoroughly enjoy.

Museums and historical sites

- **National Museum of Ethiopia** – Ethiopia is known as the “cradle of mankind”. So don’t miss out on the opportunity to witness the first ever of our kind Lucy (Australopithecus afarensis) and her progeny Selam.
- **The National Palace** – significant landmark in Ethiopian history and serves as the official residence of the President of Ethiopia. Located in the capital city of Addis Ababa, the palace has witnessed numerous pivotal events throughout the country’s history. Originally built in the late 1950s to early 1960s to mark Emperor Haile Selassie’s Silver Jubilee, the National Palace stands as a symbol of Ethiopia’s modernization efforts during that era. Its architecture blends modernist and Ethiopian traditional influences, reflecting the country’s rich cultural heritage and aspirations for progress.
- **Adwa Museum** – a venue for rejuvenating the spirit of Pan-Africanism and as a memorial dedicated to African Victory. The museum houses versatile spaces, including the Adwa memorial museum, an amphitheater, libraries, and youth centers.
- **Unity Park** – This park is packed with historical sites from great the Solomonic Dynasty of Ethiopia on every corner. This includes, Menelik II’s Palace Complex, The Throne Hall or Throne House and Banquet Hall.
- **Ethiopian Science Museum** – incorporates several building complexes and interactive display screens in local solutions in health-care, finance, cybersecurity, geographic information system (GIS), service industries, data analysis, manufacturing, and robotics.

Parks & recreations

- **Sheger Park** – walk in the beautiful garden with lush greenery, ponds and amazing wa-

ter works located in downtown Addis with wonderful city skyline.

- **Unity Park** – an educative and relaxing experience in lush gardens and captivating zoo which includes Black-maned Lion Zoo, Indigenous Garden, Unity Botanical Garden and Unity Zoo.

Shopping

- **Mercato** – the largest open market in Africa! This is the bustling hot pot of commerce in Ethiopia where anything imaginable is traded. (Note: visit with local guide and care for personal belonging is highly advised.)
- **Shiro Meda** – if you ever wondered where and how the famous and stunning Ethiopian traditional clothing are made, then Shiro Meda is the spot! This bustling market houses the most creative craftsmen/women in Ethiopian embroidery and cotton (Shema) weaving. (Note: visit with local guide and care for personal belonging is highly advised.)
- **Salem Ethiopia & Entoto Beth Artisan** – buy high-end, well curated traditional clothing and creative local artisanal products.

Local arts & music

- **Fendika Cultural Center** – engross yourself in cultural dance and creative music experience.
- **Studio11** – a place that celebrates local art, curates extraordinary events, builds a resilient artist community, and elevate female visual artists in Ethiopia.

Gastronomy

- **Injera**: Ethiopian flatbread, the foundation of most dishes
- **Doro Wet**: Spicy chicken stew with cooked egg
- **Kitfo** : Spicy minced buttered
- **beef Shiro**: vegetarian chickpea stew
- **Tibs & Kurt**: sautéed meat with spices and raw meat with chili sauce

Ethiopia is the birthplace of coffee – the name comes from the Kaffa region. Don’t miss a traditional coffee ceremony, a social ritual where coffee is roasted, brewed, and served in three rounds: *abol*, *tona*, *baraka*.

Useful information

- *Currency: Ethiopian Birr (ETB)*
- *Electricity: 220V with Type C, E, or F plugs*
- *Languages: Amharic is official; English widely understood in business settings*

Practical tips & other facts

- *Smoking in public is generally discouraged.*
- *Eating with your hands is common: wash your hands before the meal and only use your right hand.*
- *In some cultures licking the fingers is a compliment to the chef, in Ethiopia - where meals are often shared from a big plate – this is impolite.*

Calendar

Ethiopia follows its own calendar – about 7 to 8 years behind the Gregorian calendar. It has 13 months (12 months of 30 days, plus a 13th month of 5 or 6 days).

New Year falls in September, and the current Ethiopian year is 2017.

Country snapshot

- *Capital: Addis Ababa (which means “New flower” in Amharic).*
- *Location: Horn of Africa.*
- *Borders: Sudan, South Sudan, Kenya, Somalia, Eritrea, Djibouti*
- *Government: Federal parliamentary republic.*
- *Administrative structure: 11 regional states + 2 city administrations.*
- *National day: 28 May (commemorates the fall of the Derg regime in 1991).*

Security guide for Addis Ababa

Street-level safety

- *Carry only necessary cash (2,000 ETB or about 35 USD maximum).*
- *Store passports, laptops, and extra cash in your hotel safe.*
- *Keep phones and electronics concealed in crowded areas.*
- *Avoid displaying valuables near open car windows.*

Transportation safety

- *Use only registered taxi services: Like RIDE or FERES apps for tracked rides. Always confirm your destination with the driver before entering.*
- *Avoid walking alone after 7 PM.*
- *Stay on well-lit main streets for walking.*

Scam prevention

At the airport:

- *Proceed directly to official hotel shuttles.*
- *Decline offers from unofficial baggage handlers.*
- *Exchange currency only at banks or authorized locations.*

Emergency contacts

- *Police: 991*
- *Ambulance: 907*

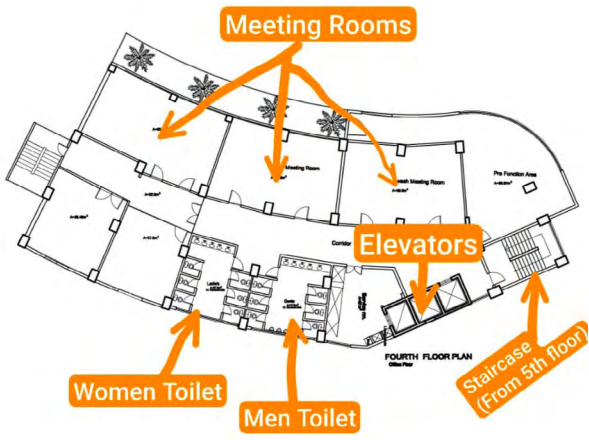
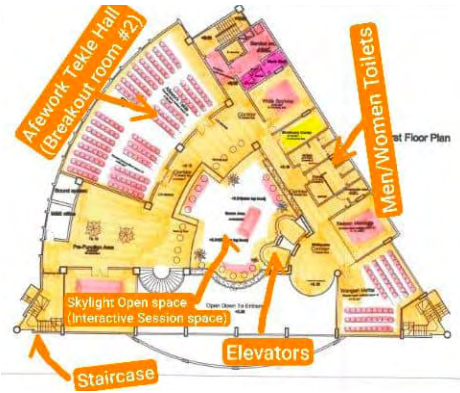
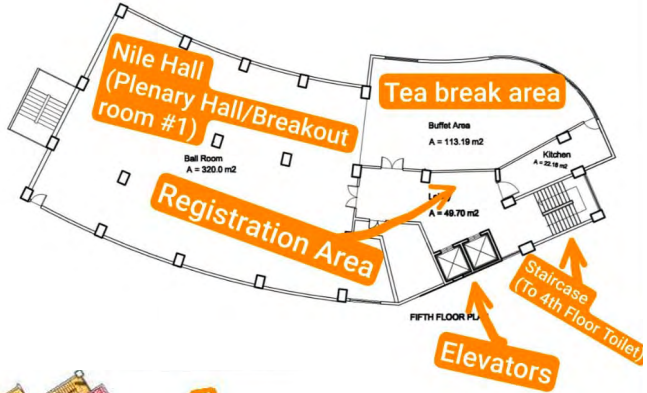

#ATIGeneralAssembly
#ATIGA25

 International Tax Compact



Find us online
www.addistaxinitiative.net

Funded by



Co-funded by
the European Union

Facilitated by

